

IK20, IK21, IK22

CEILING UNIT RANGEHOOD INSTRUCTIONS MANUAL



12-14 Charlies Way, Frankton, Hamilton, New Zealand, 3204
www.ikon.nz
Published May 2016

INTRODUCTION OF DEVICE

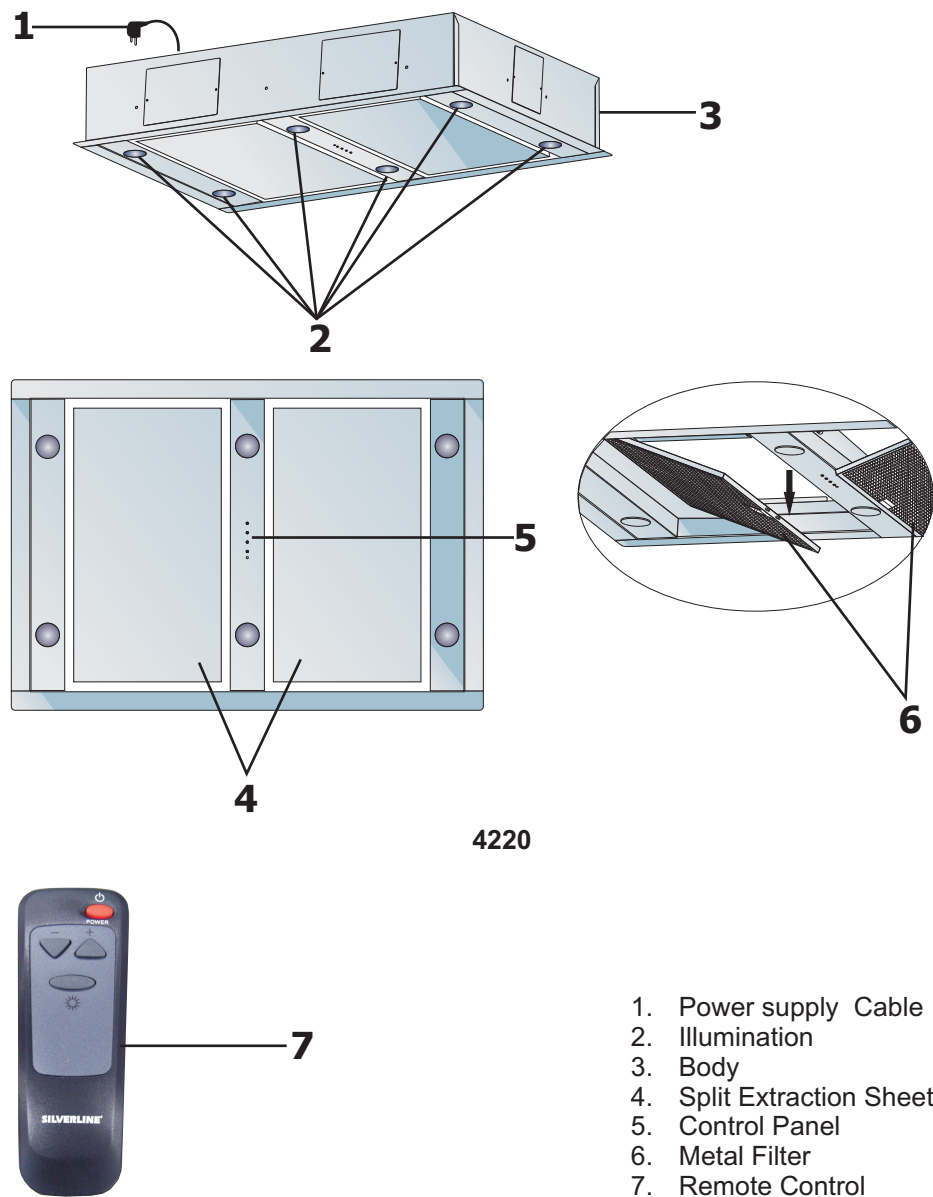

Figure 1

Using Remote Control

Your product can be operated by remote control
You may see following instructions to use your remote control

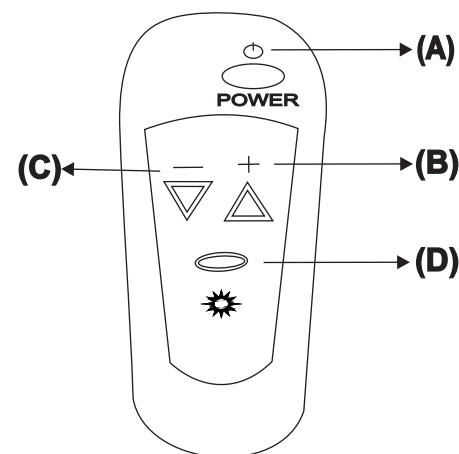

Figure 8

A – On/Off
B – Speed Up
C – Speed Down
D – Lamp On/Off

TECHNICAL SPECIFICATIONS

Model	4220
Feeding Voltage	220-240 V 50Hz
Lamp Power (W)	6 x 50 W

In order to use the cooker hood efficiently:

*Use ducts of 150/120mm diameter and as few bends as possible when you make the chimney connection.

*Pay attention to aluminum filters' cleaning periods and changing periods of carbon filters.

*Use the product at middle speed if high suction power is not necessary.

* In order to ensure that ventilation occurs correctly, windows of the kitchen should be kept closed.

LAMPS: There are 3 groups of lamps in your product. When pressed on lamp button when lighting is off, two lamps on the middle will illuminate. When pressed again, two lamps on middle will be deactivated and 4 lamps on the sides will illuminate. All lamps will be deactivated when pressed on light button again.

- 1st Group Lamp:** When pressed on lamp button when lighting is off, two lamps on the middle will illuminate.
- 2nd Group Lamp:** When pressed on lamp button in 3 seconds, two lamps on middle will be deactivated and 4 lamps on the sides will illuminate.
- 3rd Group Lamp:** When pressed on lamp button in 3 seconds, all lamps are illuminated. In this way, your product has 3 levels for lighting. When pressed on light button when lights are on, both groups of lamps will be deactivated.

NOTE: Unless any change made in the position of the hood for 4 hours, the hood will turn-off which means if only the motor is on, it will turn-off; if only lamps are on, they will turn-off; and if both are on, they will both turn-off.

NOTE: If the remote control or the product breakdowns, you can turn off the product by using on/off switch in the product.

	Check electric connection (Voltage of the electric network should be between 220-240V, cooker hood should be connected to grounded plug.)	Check motor switch (Motor switch should be at on position)	Check lamp switch (Lamp switch should be at on position)	Check aluminum filter (Aluminum Cassette Filter should be washed once a month at normal conditions.)
Cooker-hood does not work	X			
Illumination Lamp does not work	X		X	
Cooker-hoods air suction is weak		X		X

If the product does not work:

Before you contact the technical service:

Make sure that the product is plugged in and the electric fuse of the electric wiring is running. Do not take any action that will damage the product. Before you contact with technical service, check your cooker hood according to Table 1. If the problem goes on, contact the seller or the most authorized service.

Technician Figure EXAMPLE (not IK20, IK21 or IK22)

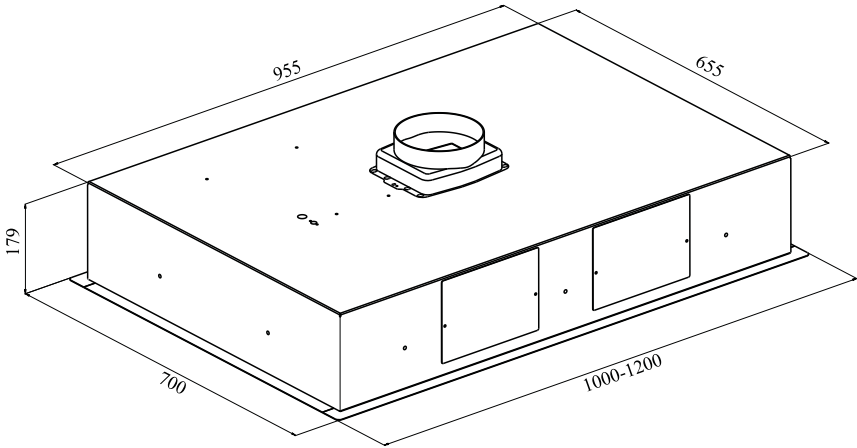

EXAMPLE

Figure 2

WARNINGS AND SAFETY PRECAUTIONS

- *This product is designed for usage at home.
- *Your products usage voltage is 220-240 Volts~50Hz
- *Grounded plug is used at your product's electric network cable. This cable should definitely be plugged in a grounded socket.
- *All electrical networks should be set by a qualified electrician.
- *Installation applied by unauthorized people may cause the product to operate at low performance, damage of the product and accidents.
- *Power supply cable should not be exposed to press or smash during montage. Network cordon should not be placed near the cookers; it may cause fire if it melts.
- *Do not plug into the socket before installation of the product is completed.
- *Keep the plug at a reachable place so that you can unplug it in case of any danger.
- *Do not touch the lamps when they are on for long time. Lamps may hurt your hand as they will be hot.
- *Kitchen cooker hoods are designed for usage during normal and home-style cooking. If it is used for other purposes, failure risk occurs and it will be out of warranty.
- *Follow applicable rules and directions for passing out outlet air. (This warning is not valid for usage without chimney.)

- *Flaming foods should not be cooked under the product.
- *Start your product after you put pot, fry-pan etc. on the hob. Otherwise high temperature may cause some parts of your product to get deformed.
- *Before you take pot, fry-pan etc. from the hob, put their lids on.
- *Do not leave hot oil on the hob. Pots that have hot oil in them may cause self-ignition.
- *Pay attention to curtains and covers during cooking of meals like frying because oil may flare up.
- *Make sure that filters are changed in convenience. Filters that are not changed at appropriate time has risk of causing fire due to oil that will be gathered on them.
- *Do not use filter materials that are not flame resistant instead of filter.
- *Do not operate your product without aluminum filter; do not remove filters when the product is on.
- *In case of flame, cut power of the product and the cooking appliances. (Cut power of the product by plugging it off the socket).
- *Your product may cause fire risk if cleaning is not applied periodically.
- *Cut power of the product before maintenance process. (Cut power of the device by unplugging it)

Efficient Ventilation

In order to ensure correct ventilation, keep your kitchen windows closed.

IMPORTANT NOTE

Please pay attention when the product is operated at the same time with a product which operates using air and fuel (for instance; heater, water heater etc. which operates using gas, diesel fuel, coal or wood), since cooker hood may affect burning negatively as it directs the air out.

This warning is not valid for usage without chimney.

There is no control button on the hood. The hood can only be operated by remote control.

Functions of Remote Control and Buttons:

Mon/Off: Use this button for activating and deactivating the motor. The starting speed of the motor is **1**. The numbers of motor speeds are shown by LED on the same number of operating speeds. In 1st speed, the leftmost LED is on; in 2nd cycle, two LEDs from the left are on, etc.

SPEED –: This option is functional when the motor operates. At each time you press this button, the motor speed will be reduced to the next lower level (Minimum level is 1).

Timer Feature: Timer can be activated by pressing “**speed -**” button. This option is functional when the motor operates. Press and hold (2 seconds) this button to start the motor operating timing of 15 minutes. The flashing rightmost LED shows that the timer function is activated. The motor stops when the 15 minutes period is over. The timer will be deactivated in case of speed change when the timer is active.

SPEED+: This option is functional when the motor operates. Each time you press this button, the motor speed will be increased to the next up level (maximum level is 4).

Illumination:

This device has three illumination settings. You can light-up two, four or six halogen lamps simultaneously as you wish.

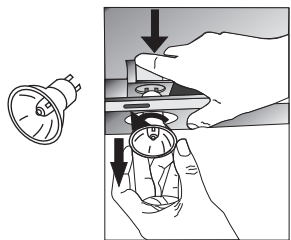

Figure 6

Replacing the Lamps

Cut off the connection of the cooker hood with electricity. Take off the aluminum cassette filter. Take off the failed lamp and replace it with a new one that is of the same rating. (Please wait for the lamps to cool as they might hurt your hand.)

Replacing 50W Halogen Lamp

In order to change halogen lamps, take the lamp downwards pushing back of lamp holder downwards and then turning it a little bit anti-clockwise take it off downwards. **Figure 6**

Functions of the Product

Your hood is compatible for use with or without chimney.

Usage with chimney

The product should be connected to a chimney that will direct the air out during usage with chimney. In order to achieve best performance, pay attention that the duct system follows the shortest way for connection to the chimney. Your product is produced as it will be appropriate for usage with chimney.

Attention!!!

Outlet of the product should not be connected to air canals that have other smoke as well.

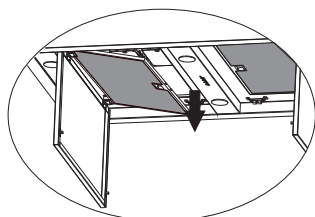

Figure 7



**Washable Aluminum
Cassette Filter**

Picture 4

MAINTENANCE

*Disconnect electricity connection before maintenance and cleaning process.

*Aluminum cassette filter holds the dust and the oil in the air.

*Metal filter should be washed once in a month with hot and soaped water or, if possible, at dishwasher (60C).

*Take off aluminum cassette filter pressing on springy latches on end point. After cleaning, do not replace before it dries.

*Outer surface of the cooker hood should be wiped with a wet cloth that is wetted with water or alcohol.

*Please avoid contact of electronic parts with water or similar materials.

*Using Inox cleaning and maintenance products available in the market will help your product to perform longer.

Warning: Aluminum filters may be washed in the dishwasher. Color of aluminum filters may change after several washings. This is normal and it is not necessary to change the filters.

*When chimney hood and the appliances working with energy other than electricity are operated at the same time, negative pressure in the room should not be more than 4 Pa (4 x 10⁻⁵ bar)

*If there is an appliance working with fuel or gaseous fuel at the same place with your hood, this appliance's exhaust should be isolated from its volume totally and the appliance should be hermetic type.

*When chimney connection is applied to your product, use ducts of 150mm or 120mm diameter. Duct connection should be as short as possible and should include few bends.

*Keep package materials away from children as they may be dangerous for them.

Warning about Transportation and Carriage

*All the materials used at package of your product are suitable for recycling.

*Please comply with the signs on the product's box during transportation.

*Hold the holders placed at sides of the box in order to carry your product.

If you need transportation;

*Keep the original box.

*Carry your product in its original box; comply with the carrying signs on the product's box.

If there is no original package;

*Do not put heavy material on the chimney hood.

*Keep the external surface from bash.

*Pack your product to avoid damages.

Installation, taking off your product from its package:

*Check if there is any deformation on your product.

*Transportation damages and failures should immediately be reported to the transportation responsible.

*If you notice any damage please report to the seller.

***Do not allow children to play with packing material!!!**

*Be sure that your child does not play with the product. Do not allow kids to use your product.

*If power supply cable is damaged, this cable should be changed by its producer or its service agency or a personnel who is a specialist at the same level in order to prevent a dangerous situation.

*In case of flame, cut power of the cooker hood and the cooking appliances, cover the flame. Never use water in order to extinguish it.

**Use "MAX 6 A" fuse at cooker hood
installment for your security.**

Standard Accessories

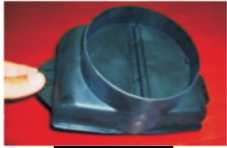

Picture 1

Plastic chimney

Plastic chimney, assembled to air outlet of aspirator
(Picture 1)

Installation, taking off your product from its package:

- *Check if there is any deformation on your product.
- *Transportation damages and failures should immediately be reported to the transportation responsible.
- *If you notice any damage please report to the seller.
- ***Do not allow children to play with packing material!!!**

INSTALLATION THE HOOD

External ventilation units must be used for ceiling model hoods.

Before mounting of ceiling hoods, make the connections of previously selected external ventilation system, and prepare the air outlet duct of 150 mm diameter and the part which will be mounted to the ceiling, and fix the plastic chimney to flexi pipe by using a clamp. After installing the hood on the ceiling, pull the plastic chimney and fix it with wing nuts. Air outlet can be provided from any side of the device. Unused air outlet hole should be closed.

- * For installing the hood to the ceiling, there should be a section on the ceiling that corresponds to sizes given in technical drawing. Drill an opening for the plastic chimney appropriate to the position of the air outlet.

Connection of External Ventilation Unit with the Hood:

- * Open the split-extraction sheet of the device and remove the filter (Figures 3 & 4).

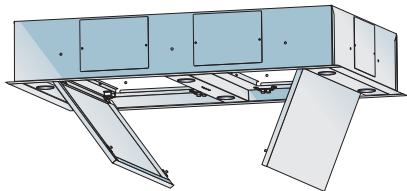

Figure 3

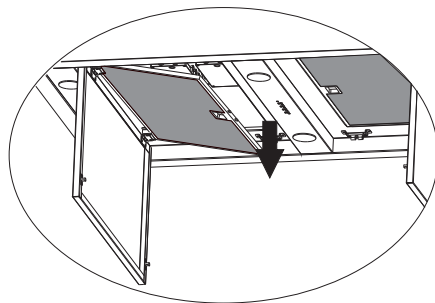
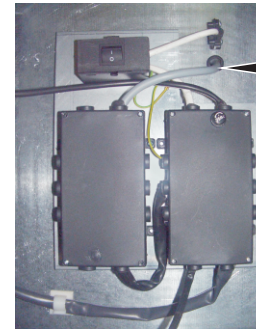

Figure 4

Pull the cable coming from external ventilation unit, and drive it 30cm into from the hole located on the upper side of the hood.



Picture 2

Cable coming from external ventilation unit.

Cut off the electrical connection of the hood. For such situations, turn off the fuse of the hood.

- * Place the hood on the section determined on the ceiling, and screw it to the ceiling as shown in Figure 5.

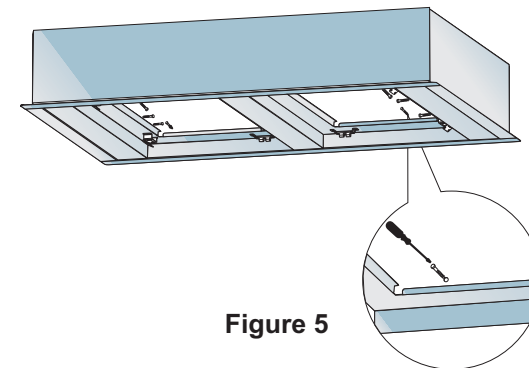

Figure 5

In order to have the best performance avoid bends on aluminium flexible duct.



Correct



Incorrect

Picture 3