



Installation and User Manual

Model: IK15 & IK16



KITCHEN/LAUNDRY SINKS



BATHROOM BASINS



TAPWARE



RANGEHOODS



COOKTOPS



WASTE DISPOSALS

MONTAGE INSTRUCTIONS OF 1250 EXTERNAL MOTOR

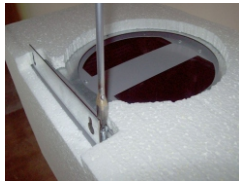

Photo 1

Montage of Hanging Bar:

There are 2 pieces L formed hanging plates for installation of external motor to appropriate place. These are given with screw set. Screw these plates with M5 x 40 thumbscrews to M5 turnscrews on external motor cabinet. **Photo 1**



Photo 2

DRIVING WALL PLUGS IN

Drive 8mm holes on the surface that external motor will be hang. Nail Ø10 mm wall plugs to (A,B) holes. (Photo 2)

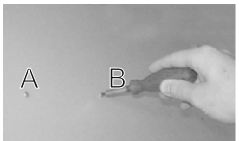

Photo 3

NAILING WALL PLUGS

Nail hanging screws to 10mm wall plugs with (A,B) 5,5x60 thumbscrews. There should be 5mm distance between screw head and wall. **Photo 3**



Photo 4

Montage of Plastic Chimney Fix Plastic Chimney to motor connection plate with 3,5x9,5 screw. **Photo 4**

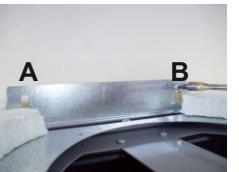

Photo 5

Hanging External Motor

Holding external motor on its body, hang it on the wall with (L) plate that you connected previously through A and B points. **Photo 5**

MONTAGE OF ALUMINUM FLEXIBLE DUCTS



Photo 6

Mount the aluminum flexible duct on plastic chimney that is on top of the hood. **(Photo 6)**

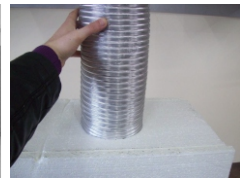

Photo 7

Mount the other end of aluminum flexible duct to air-inlet of external motor. **(Photo 7 and Photo 9)**. Then mount one end of the aluminum flexible duct to air-outlet of external



Photo 8

motor **(Photo 8, Photo 4, Photo 9)** and the other end to the chimney that is used to let

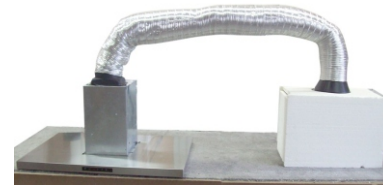

Photo 9

air off. In order to prevent aluminum ducts and chimneys to disconnect because of air circulation, strengthen their connectin using bracket.

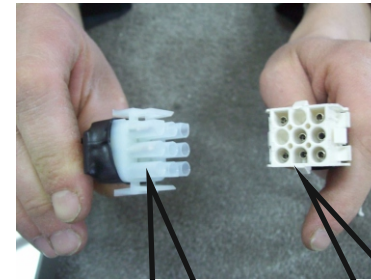

Photo 10

Cable of Chimney Hood

Cable of External Motor



Photo 11

Cable Connection

Necessary connections should be done in order to control external motor using chimney hood. Connect cable of chimney hood to cable of external motor. **(Photo 10-11)**

MONTAGE INSTRUCTIONS OF 1240 EXTERNAL MOTOR



Photo 1

Montage of Hanging Bar:

There are 2 pieces L formed hanging plates for installation of external motor to appropriate place. These are given with screw set. Screw these plates with M5 x 40 thumbscrews to M5 turnscrews on external motor cabinet. **Photo 1**



Photo 2

DRIVING WALL PLUGS IN

Drive 8mm holes on the surface that external motor will be hang. Nail Ø10 mm wall plugs to (A,B) holes. **(Photo 2)**

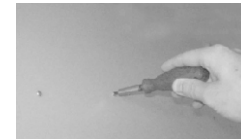

Photo 3

NAILING WALL PLUGS

Nail hanging screws to 10mm wall plugs with (A,B) 5,5x60 thumbscrews. There should be 5mm distance between screw head and wall. **Photo 3**

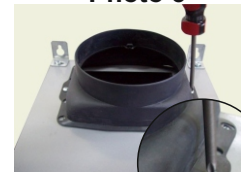
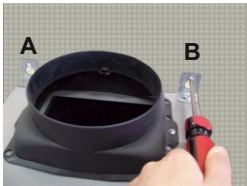

Photo 4

Montage of Ø 200 mm Plastic Chimney Adaptor

Mount Ø 200mm Plastic Chimney Adaptor to air-outlet of external motor and fix it to the chimney hood with 3,5x9,5 screw. Screws are given with screw set. **Photo 4**



Hanging of External Motor

Holding external motor on its body, hang it to the wall on (L) plates that you montaged to external motor through A and B points.

Photo 5

Photo 5

MONTAGE OF ALUMINUM FLEXIBLE DUCTS



Photo 6



Photo 7



Photo 8

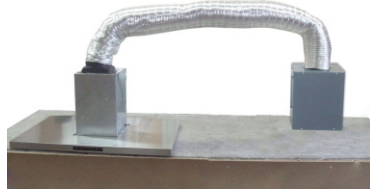

Photo 9

Mount the aluminum flexible duct on plastic chimney that is on top of the hood. **(Photo 6)** Mount the other end of aluminum flexible duct to air-inlet of external motor. **(Photo 7 and Photo 9)**. Then mount one end of the aluminum flexible duct to air-outlet of external motor **(Photo 8, Photo 4, Photo 9)** and the other end to the chimney that is used to let air off. In order to prevent aluminum ducts and chimneys to disconnect because of air circulation, strengthen their connectin using bracket.

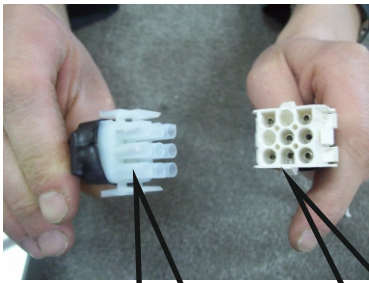

Photo 10

Cable of Chimney Hood

Cable of External Motor



Photo 11

Cable Connection

Necessary Connections should be done in order to control external motor using chimney hood. Connect cable of chimney hood to cable of external motor. **(Photo 10-11)**

EXTERNAL MOTOR MONTAGE SCHEME

